

At-a-Glance Schedule



Conference on the Life Sciences

June 10–13, 2024

Hilton Portland Downtown • Portland, Oregon, U.S.

Conference on Mathematics of Planet Earth

June 10–12, 2024

Hilton Portland Downtown • Portland, Oregon, U.S.

Online Program and Mobile App

Attendees are encouraged to visit the following to view the Online Program Schedule:

LS24 <https://www.siam.org/conferences/cm/program/program-and-abstracts/ls24-program-abstracts>

or

MPE24 <https://www.siam.org/conferences/cm/program/program-and-abstracts/mpe24-program-abstracts>

to view the Online Program Schedules.

The Mobile App and Online Program Schedule contain the most up-to-date information.

A searchable abstract document is also posted.

SIAM Events Mobile App



www.tripbuildermedia.com/apps/siam

siam | Society for Industrial and
Applied Mathematics

3600 Market Street, 6th Floor
Philadelphia, PA 19104-2688 U.S.
Telephone: +1-215-382-9800

Conference Email: meetings@siam.org • Conference Web: www.siam.org/conferences
Membership and Customer Service: (800) 447-7426 (U.S. & Canada) or +1-215-382-9800 (worldwide)

<https://www.siam.org/conferences/cm/conference/ls24>
<https://www.siam.org/conferences/cm/conference/mpe24>

Sunday, June 9

4:00 p.m. – 6:00 p.m.

Registration

Atrium/Pavilion Foyer - Plaza Level

Monday, June 10

7:45 a.m. – 8:15 p.m.

Registration

Atrium/Pavilion Foyer - Plaza Level

8:30 a.m. – 8:45 a.m.

Opening Remarks

Grand I - Ballroom Level

8:45 a.m. – 9:30 a.m.

IP1 Quantitative Ecology of Host-associated Microbiomes

Lei Dai, Shenzhen Institute of Advanced

Technology, Chinese Academy of Sciences, China

Grand I - Ballroom Level

9:30 a.m. – 10:00 a.m.

Coffee Break

Atrium/Pavilion Foyer - Plaza Level

9:30 a.m. – 5:00 p.m.

Exhibitor Hours

Atrium/Pavilion Foyer - Plaza Level

10:00 a.m. – 12:00 p.m.

Concurrent Sessions

MS1 Biomechanics and Biofluids in Physiology and Morphogenesis

Grand I - Ballroom Level

MS2 Mathematical Modeling Applications in Women's and Children's Health - Part I of II

Pavilion East - Plaza Level

MS3 Stochastic Processes in Cellular Signaling - Part I of II

Pavilion West - Plaza Level

MS4 Mechanisms of Cell Migration from

Intracellular to eExtracellular Interactions - Part I of II

Galleria III - Ballroom Level

MS5 Biological Dynamics Across the Many Natural Scales - Part I of II

Broadway I - Plaza Level

MS6 Epidemiological Modeling Across Scales - Part I of II

Broadway II - Plaza Level

MS7 Discrete Biological Network Models in Biology - Part I of II

Broadway III - Plaza Level

MS8 Data-driven Modeling and Learning Methods in Biology and Medicine - Part I of II

Broadway IV - Plaza Level

Monday, June 10

CP1 Mathematical Modeling of Cellular Dynamics and Pattern Formation

Parlor A - Ballroom Level

CP2 Network in Biology

Parlor B - Ballroom Level

CP3 Mathematical Modeling of Vector-Borne Diseases

Parlor C - Ballroom Level

12:00 p.m. – 1:30 p.m.

Lunch Break

1:30 p.m. – 2:15 p.m.

IP2 Investigating Single-scale and Multi-scale Heterogeneous Immune Responses During Cancer Evolution

Raluca Eftimie, University of Franche-Comté, France

Grand I - Ballroom Level

2:15 p.m. – 2:45 p.m.

Coffee Break

Atrium/Pavilion Foyer - Plaza Level

2:45 p.m. – 4:45 p.m.

Concurrent Sessions

MT1 Parameter Inference

Grand I - Ballroom Level

MS9 Mathematical Modeling Applications in

Women's and Children's Health - Part II of II

Pavilion East - Plaza Level

MS10 Stochastic Processes in Cellular Signaling - Part II of II

Pavilion West - Plaza Level

MS11 Mechanisms of Cell Migration from

Intracellular to eExtracellular Interactions - Part II of II

Galleria III - Ballroom Level

MS12 Biological Dynamics Across the Many

Natural Scales - Part II of II

Broadway I - Plaza Level

MS13 Epidemiological Modeling Across Scales - Part II of II

Broadway II - Plaza Level

MS14 Discrete Biological Network Models in

Biology - Part II of II

Broadway III - Plaza Level

MS15 Data-driven Modeling and Learning Methods in Biology and Medicine - Part II of II

Broadway IV - Plaza Level

MS16 Mathematical Models of Cancer Dynamics Under Treatment

Parlor A - Ballroom Level

MS17 Dynamics of Cell Regulatory Proteins with

Connections to Cellular Processes

Parlor B - Ballroom Level

CP4 Neuroscience

Parlor C - Ballroom Level

Monday, June 10

4:45 p.m. – 5:00 p.m.

Intermission

5:00 p.m. – 7:00 p.m.

PP1 Joint Welcome Reception and Poster Session

Atrium Ballroom - Plaza Level

Tuesday, June 11

8:15 a.m. – 8:15 p.m.

Registration

Atrium/Pavilion Foyer - Plaza Level

8:40 a.m. – 8:45 a.m.

Remarks

Grand I - Ballroom Level

8:45 a.m. – 9:30 a.m.

IP3 Modeling Life: A SLACer's Journey

Erica J. Graham, Bryn Mawr College, U.S.

Grand I - Ballroom Level

9:30 a.m. – 10:00 a.m.

Coffee Break

Atrium/Pavilion Foyer - Plaza Level

9:30 a.m. – 5:00 p.m.

Exhibitor Hours

Atrium/Pavilion Foyer - Plaza Level

10:00 a.m. – 12:00 p.m.

Concurrent Sessions

MS18 Emergent Collective Behaviors in Biology

Grand I - Ballroom Level

MS19 Mathematics in the Pharmaceutical Sciences: An Industry Perspective

Pavilion East - Plaza Level

MS20 The Role of Mathematics for Life Science Education

Pavilion West - Plaza Level

MS21 Dynamics of Socially- and Behaviorally-structured Multi-population and Multiagent Systems - Part I of II

Galleria III - Ballroom Level

MS22 Models and Simulations of Hemostasis and Thrombosis - Part I of II

Broadway I - Plaza Level

MS23 Statistical Mechanics of Cellular

Differentiation and Reprogramming - Part I of II

Broadway II - Plaza Level

MS24 Mathematical Insights in Neuroscience: From Theory to Reality - Part I of II

Broadway III - Plaza Level

MS25 Evolutionary Game Theory for Modeling Biological and Social Systems - Part I of II

Broadway IV - Plaza Level

Tuesday, June 11

Tuesday, June 11

Wednesday, June 12

CP5 Immunology and Oncology*Parlor A - Ballroom Level***CP6** Ecology*Parlor B - Ballroom Level***CP7** Epidemiology Viral Transmission*Parlor C - Ballroom Level***12:00 p.m. – 1:30 p.m.**

Lunch Break

1:30 p.m. – 2:15 p.m.

JP1 LS/MPE24 Joint Plenary Presentation - Thermal Dynamics of Host-Parasite Systems: Modelling and Predicting Disease Emergence and Range Changes in a Warming Climate
Péter Molnár, University of Toronto, Canada
Grand I - Ballroom Level

1:30 p.m. – 4:45 p.m.

Workshop: Research in Biomathematics: A Guide To Funding From the U.S. Army Research Office
<https://systemsmedicine.pulmonary.medicine.ufl.edu/news-and-events/research-in-biomathematics-a-guide-to-funding-from-the-u-s-army-research-office/>
Galleria II - Ballroom Level

2:15 p.m. – 2:45 p.m.

Coffee Break

*Atrium/Pavilion Foyer - Plaza Level***2:45 p.m. – 4:45 p.m.****Concurrent Sessions****MT2** Sensitivity Analysis in the Life Sciences*Grand I - Ballroom Level***MS26** Predictive Modeling of Clinical Endpoints to Advance Model-informed Drug Development*Pavilion East - Plaza Level***MS27** Broadening Mathematics Interest through CUREs in Mathematical Biology*Pavilion West - Plaza Level***MS28** Dynamics of Socially- and Behaviorally-structured Multi-population and Multiagent Systems - Part II of II*Galleria III - Ballroom Level***MS29** Models and Simulations of Hemostasis and Thrombosis - Part II of II*Broadway I - Plaza Level***MS30** Statistical Mechanics of Cellular

Differentiation and Reprogramming - Part II of II

*Broadway II - Plaza Level***MS31** Mathematical Insights in Neuroscience: From Theory to Reality - Part II of II*Broadway III - Plaza Level***MS32** Evolutionary Game Theory for Modeling Biological and Social Systems - Part II of II*Broadway IV - Plaza Level***MS33** Highlighting LGBT+ Mathematicians in the Life Sciences*Parlor A - Ballroom Level***CP8** Ophthalmology & Imaging*Parlor B - Ballroom Level***4:45 p.m. – 5:00 p.m.**

Intermission

5:00 p.m. – 6:00 p.m.

PD1 Career Panel: Shedding Light on Opportunities for Applied Mathematicians in Industry and Government
Grand I - Ballroom Level

6:00 p.m. – 7:00 p.m.

PD2 Funding Panel
Grand I - Ballroom Level

Wednesday, June 12

8:15 a.m. – 3:00 p.m.

Registration

*Atrium/Pavilion Foyer - Plaza Level***8:40 a.m. – 8:45 a.m.**

Remarks

*Grand I - Ballroom Level***8:45 a.m. – 9:30 a.m.**

IP4 Role of Mathematical Modeling in Development and Roll Out of Vaccines
Elamin Elbasha, Merck & Co., Inc., U.S.
Grand I - Ballroom Level

9:30 a.m. – 10:00 a.m.

Coffee Break

*Atrium/Pavilion Foyer - Plaza Level***9:30 a.m. – 5:00 p.m.**

Exhibitor Hours

*Atrium/Pavilion Foyer - Plaza Level***10:00 a.m. – 12:00 p.m.****Concurrent Sessions****MS35** Data-driven Modeling of Spatial Subcellular Processes - Part I of II*Pavilion East - Plaza Level***MS36** Biological Applications of the Immersed Boundary Method - Part I of II*Pavilion West - Plaza Level***MS37** Digital Twins Versus Virtual Populations in Quantitative Systems Pharmacology Modeling - Part I of II*Galleria III - Ballroom Level***MS38** Mathematics and Machine Learning in Biophysics - Part I of II*Broadway I - Plaza Level***MS39** Challenges in Modeling Ecological and Epidemiological Processes*Broadway II - Plaza Level***MS40** Data-driven Approaches in Infectious Disease Modeling - Part I of II*Broadway III - Plaza Level***MS41** Decision-making in Dynamic Environments
*Broadway IV - Plaza Level***MS42** Intersection of Cancer and Cardiovascular Modeling*Parlor A - Ballroom Level***CP9** Multi-Scale Disease Dynamics*Parlor B - Ballroom Level***CP10** Modeling and Analysis Across Scales I*Parlor C - Ballroom Level***12:00 p.m. – 1:30 p.m.**

Lunch Break

1:30 p.m. – 2:15 p.m.

IP5 The Future of Pandemic Modeling in Support of Decision Making: Lessons Learned from COVID-19
Sara Del Valle, Los Alamos National Laboratory, U.S.
Grand I - Ballroom Level

2:15 p.m. – 2:45 p.m.

Coffee Break

*Atrium/Pavilion Foyer - Plaza Level***2:45 p.m. – 4:45 p.m.****Concurrent Sessions****MS44** Data-driven Modeling of Spatial Subcellular Processes - Part II of II*Pavilion East - Plaza Level***MS45** Biological Applications of the Immersed Boundary Method - Part II of II*Pavilion West - Plaza Level***MS46** Digital Twins Versus Virtual Populations in Quantitative Systems Pharmacology Modeling - Part II of II*Galleria III - Ballroom Level***MS47** Mathematics and Machine Learning in Biophysics - Part II of II*Broadway I - Plaza Level***MS48** Mechanistic Learning: at the Interface of Mechanistic Mathematical Modeling and Data Science*Broadway II - Plaza Level***MS49** Data-driven Approaches in Infectious Disease Modeling - Part II of II*Broadway III - Plaza Level***MS50** The Use of First Principles for Modeling Biosystems*Broadway IV - Plaza Level***CP11** Biofilm & Motility*Parlor A - Ballroom Level***CP12** Evolution and Ecology*Parlor B - Ballroom Level*

Wednesday, June 12**Thursday, June 13**

CP13 Modeling and Analysis Across Scales II
Parlor C - Ballroom Level

4:45 p.m. – 5:00 p.m.

Intermission

5:00 p.m. – 5:45 p.m.

SIAG/LS Business Meeting

Complimentary beer and wine will be served

Grand I - Ballroom Level

MS58 Mathematical Modeling of Cancer Dynamics
Broadway IV - Plaza Level

12:00 p.m. – 1:30 p.m.

Lunch Break

1:30 p.m. – 1:45 p.m.

Closing Remarks

Grand I - Ballroom Level

1:45 p.m. – 2:15 p.m.

SP1 SIAM Activity Group on the Life Sciences
(SIAG/LS) Early Career Prize Lecture - COVID-19:

Why Do Some Get Sick, and Some Feel Fine?

Adrienne L. Jenner, Queensland University of

Technology, Australia

Grand I - Ballroom Level

2:15 p.m. – 2:45 p.m.

Coffee Break

Atrium/Pavilion Foyer - Plaza Level

2:45 p.m. – 4:45 p.m.

Concurrent Sessions

MS43 Insights from Stochasticity in Intracellular
Processes - Part II of II

Grand I - Ballroom Level

MS59 Numerical Methods in Biological Fluid

Dynamics - Part II of II

Pavilion East - Plaza Level

MS60 Mechanistic Modeling from Inter- to Intra-

cellular Phenomena - Part II of II

Pavilion West - Plaza Level

MS61 Eco-evolutionary Processes in Biology:

Mathematical and Physical Perspectives - Part II of II

Galleria III - Ballroom Level

MS62 Applied Probability and Stochastic Processes

- Part II of II

Broadway I - Plaza Level

MS63 From Data to Diagnosis: Advancements in

Prevalence Estimation and Testing

Broadway II - Plaza Level

MS64 Advances in Mathematical Models of Viral

Infections and Transmission Dynamics - Part II of II

Broadway III - Plaza Level

MS65 Advances in Computational Modeling of

Novel Tumor Treatments

Broadway IV - Plaza Level

Thursday, June 13

8:15 a.m. – 3:00 p.m.

Registration

Atrium/Pavilion Foyer - Plaza Level

8:45 a.m. – 9:30 a.m.

IP6 Epigenetic Cell Memory: Digital or Analog?
Domitilla Del Vecchio, Massachusetts Institute of
Technology, U.S.

Grand I - Ballroom Level

9:30 a.m. – 10:00 a.m.

Coffee Break

Atrium/Pavilion Foyer - Plaza Level

9:30 a.m. – 5:00 p.m.

Exhibitor Hours

Atrium/Pavilion Foyer - Plaza Level

10:00 a.m. – 12:00 p.m.

Concurrent Sessions

MS34 Insights from Stochasticity in Intracellular
Processes - Part I of II

Grand I - Ballroom Level

MS51 Mathematical AI for Biosciences

Parlor A - Ballroom Level

MS52 Numerical Methods in Biological Fluid
Dynamics - Part I of II

Pavilion East - Plaza Level

MS53 Mechanistic Modeling from Inter- to Intra-
cellular Phenomena - Part I of II

Pavilion West - Plaza Level

MS54 Eco-evolutionary Processes in Biology:

Mathematical and Physical Perspectives - Part I of II

Galleria III - Ballroom Level

MS55 Applied Probability and Stochastic Processes
- Part I of II

Broadway I - Plaza Level

MS56 Sensitivity Analysis in Biological Models:
Advances and Applications

Broadway II - Plaza Level

MS57 Advances in Mathematical Models of Viral
Infections and Transmission Dynamics - Part I of II

Broadway III - Plaza Level

ABBREVIATION KEY

CP = Contributed Presentation Session

IP = Invited Plenary Speaker

MS = Minisymposium

MT = Minitutorial

PD = Panel Discussion

PP = Poster Session

SP = Special Lecture

Sunday, June 9

Monday, June 10

Tuesday, June 11

4:00 p.m. – 6:00 p.m.

Registration

Atrium/Pavilion Foyer - Plaza Level

Monday, June 10

7:45 a.m. – 5:15 p.m.

Registration

Atrium/Pavilion Foyer - Plaza Level

8:30 a.m. – 8:45 a.m.

Opening Remarks

Grand II - Ballroom Level

8:45 a.m. – 9:30 a.m.

IP1 Tipping Points in Coupled Human-environment Systems

Madhur Anand, University of Guelph, Canada
Grand II - Ballroom Level

9:30 a.m. – 10:00 a.m.

Coffee Break

Atrium/Pavilion Foyer - Plaza Level

9:30 a.m. – 5:00 p.m.

Exhibitor Hours

Atrium/Pavilion Foyer - Plaza Level

10:00 a.m. – 12:00 p.m.

Concurrent Sessions

MS1 Accelerating Uncertainty Quantification for Models of Climate and Weather - Part I of II
Grand II - Ballroom Level

MS2 Can You Trust Your Machine-learning Model?
Galleria I - Ballroom Level

MS3 Advances in the Numerical and Statistical Modeling of Wildland Fires - Part I of III
Council - 3rd Floor

MS4 Shallow Water Simulation Using Moment Models and New Numerical Methods - Part I of II
Forum - 3rd Floor

MS5 Applications of AI for Exploring Community Systems Transition to Clean Energy - Part I of II
Directors - 3rd Floor

MS6 Computational Frameworks for MPE Applications
Studio - 3rd Floor

12:00 p.m. – 1:30 p.m.

Lunch Break

12:15 p.m. – 12:45 p.m.

Poetry Session

Invited Plenary Speaker Madhur Anand, University of Guelph, Canada, reads and discusses poems on the theme of Mathematics of Planet Earth from her two published books “A New Index for Predicting Catastrophes” and “Parasitic Oscillations”
<https://www.penguinrandomhouse.ca/authors/259994/ma-dhur-anand/>
Grand II - Ballroom Level

1:30 p.m. – 2:15 p.m.

IP2 AI for Climate: A Call for Application-driven Innovation

David Rolnick, McGill University and Mila, Canada
Grand II - Ballroom Level

2:15 p.m. – 2:45 p.m.

Coffee Break

Atrium/Pavilion Foyer - Plaza Level

2:45 p.m. – 4:45 p.m.

Concurrent Sessions

MS7 Accelerating Uncertainty Quantification for Models of Climate and Weather - Part II of II
Grand II - Ballroom Level

MS8 Advances in the Numerical and Statistical Modeling of Wildland Fires - Part II of III
Council - 3rd Floor

MS9 Dynamics-aware Dimension Reduction and Data Assimilation
Forum - 3rd Floor

MS10 Applications of AI for Exploring Community Systems Transition to Clean Energy - Part II of II
Directors - 3rd Floor

MS11 Shallow Water Simulation Using Moment Models and New Numerical Methods - Part II of II
Studio - 3rd Floor

CP1 Data-driven Methods for Earth Systems
Galleria I - Ballroom Level

4:45 p.m. – 5:00 p.m.

Intermission

5:00 p.m. – 7:00 p.m.

PP1 Joint Welcome Reception and Poster Session
Atrium Ballroom - Plaza Level

8:15 a.m. – 5:15 p.m.

Registration

Atrium/Pavilion Foyer - Plaza Level

8:40 a.m. – 8:45 a.m.

Remarks

Grand II - Ballroom Level

8:45 a.m. – 9:30 a.m.

IP3 Process and Data Informed Models: “New” Approaches, Old Ideas, and Challenges
Christopher Wikle, University of Missouri, U.S.
Grand II - Ballroom Level

9:30 a.m. – 10:00 a.m.

Coffee Break

Atrium/Pavilion Foyer - Plaza Level

9:30 a.m. – 5:00 p.m.

Exhibitor Hours

Atrium/Pavilion Foyer - Plaza Level

10:00 a.m. – 12:00 p.m.

Concurrent Sessions

MT1 Differentiable Programming in Julia with Enzyme
Grand II - Ballroom Level

MS12 Data-Driven Approaches in Weather and Climate Science
Galleria I - Ballroom Level

MS13 Advances in the Numerical and Statistical Modeling of Wildland Fires - Part III of III
Council - 3rd Floor

MS14 Mathematical Modeling of Sea Ice - Part I of II
Forum - 3rd Floor

MS15 Unstructured Numerical Methods for Spherical Problems - Part I of II
Studio - 3rd Floor

CP2 Social, Climate and Land Modeling
Directors - 3rd Floor

12:00 p.m. – 1:30 p.m.

Lunch Break

1:30 p.m. – 2:15 p.m.

JP1 LS/MPE24 Joint Plenary Presentation - Thermal Dynamics of Host-Parasite Systems: Modelling and Predicting Disease Emergence and Range Changes in a Warming Climate
Péter Molnár, University of Toronto, Canada
Grand II - Ballroom Level

2:15 p.m. – 2:45 p.m.

Coffee Break

Atrium/Pavilion Foyer - Plaza Level

Tuesday, June 11

Wednesday, June 12

2:45 p.m. – 4:45 p.m.

Concurrent Sessions

MT2 Differentiable Earth System Models in Julia
Grand II - Ballroom Level

MS16 Mathematical Modeling of Social-Ecological Systems - Part I of III
Galleria I - Ballroom Level

MS17 Mathematical Modeling of Sea Ice - Part II of II
Forum - 3rd Floor

MS18 Meshless Method Applications for Climate Change and Clean Energy Solutions
Directors - 3rd Floor

MS19 Unstructured Numerical Methods for Spherical Problems - Part II of II
Studio - 3rd Floor

2:45 p.m. – 5:05 p.m.

CP3 Foundations for the Mathematics of Planet Earth and its Extremes
Council - 3rd Floor

5:00 p.m. – 6:00 p.m.

PD1 Career Pathways for MPE Enthusiasts
Grand II - Ballroom Level

6:00 p.m. – 6:15 p.m.

Intermission

6:15 p.m. – 7:00 p.m.

SIAG/MPE Business Meeting
Complimentary beer and wine will be served
Grand II - Ballroom Level

Wednesday, June 12

8:15 a.m. – 3:00 p.m.

Registration
Atrium/Pavilion Foyer - Plaza Level

8:40 a.m. – 8:45 a.m.

Closing Remarks
Grand II - Ballroom Level

8:45 a.m. – 9:30 a.m.

IP4 Evaluating Forecasts of Extreme Events
Thordis Thorarinsdottir, University of Oslo, Norway
Grand II - Ballroom Level

9:30 a.m. – 10:00 a.m.

Coffee Break
Atrium/Pavilion Foyer - Plaza Level

9:30 a.m. – 5:00 p.m.

Exhibitor Hours
Atrium/Pavilion Foyer - Plaza Level

10:00 a.m. – 12:00 p.m.

Concurrent Sessions

MS20 Mathematical Modeling of Social-Ecological Systems - Part II of III
Grand II - Ballroom Level

MS21 Ecological and Evolutionary Directions in Invasive Species/Pest Control - Part I of II
Galleria I - Ballroom Level

MS22 Scenario Generation for Extreme Weather Event Resilience
Forum - 3rd Floor

MS23 Connecting Climate to the Undergraduate Curriculum - Part I of II
Directors - 3rd Floor

MS24 Consistent Coupling in Models of Geophysical Fluid Dynamics - Part I of II
Studio - 3rd Floor

CP4 Synergistic Computational and Modeling Techniques for Earth Systems
Council - 3rd Floor

12:00 p.m. – 1:30 p.m.

Lunch Break

1:30 p.m. – 2:30 p.m.

SP1 Activity Group on Mathematics of Planet Earth (SIAG/MPE) Early Career Prize Presentation, and the SIAG/MPE Prize Lecture - A Circuitous Journey of Computational Science around the Earth
Katherine J. Evans, Oak Ridge National Laboratory, U.S.
Grand II - Ballroom Level

2:30 p.m. – 2:45 p.m.

Coffee Break
Atrium/Pavilion Foyer - Plaza Level

2:45 p.m. – 4:45 p.m.

Concurrent Sessions

MS25 Mathematical Modeling of Social-Ecological Systems - Part III of III
Grand II - Ballroom Level

MS26 Ecological and Evolutionary Directions in Invasive Species/Pest Control - Part II of II
Galleria I - Ballroom Level

MS27 Rigorous Methods for Bayesian Computation and Reduced Order Modeling
Forum - 3rd Floor

MS28 Connecting Climate to the Undergraduate Curriculum
Directors - 3rd Floor

MS29 Consistent Coupling in Models of Geophysical Fluid Dynamics - Part II of II
Studio - 3rd Floor

CP5 Topics on Ocean Modeling
Council - 3rd Floor

ABBREVIATION KEY

CP = Contributed Presentation Session

IP = Invited Plenary Speaker

MS = Minisymposium

MT = Minitutorial

PD = Panel Discussion

PP = Poster Session

SP = Special Lecture

Thank you to our LS24 sponsor!



Thank you to our MPE24 sponsor!



SIAM and the Organizing Committee wish to extend their thanks and appreciation to the U.S. National Science Foundation and DOE Office of Advanced Scientific Computing Research for their support of these conferences.



Don't Miss our Exhibitors!

SIAM • Springer

Springer Nature advances discovery by publishing robust and insightful research, supporting the development of new areas of knowledge, making ideas and information accessible around the world, and leading the way on open access.

Hilton Portland Downtown Floor Plan

Ballroom Level

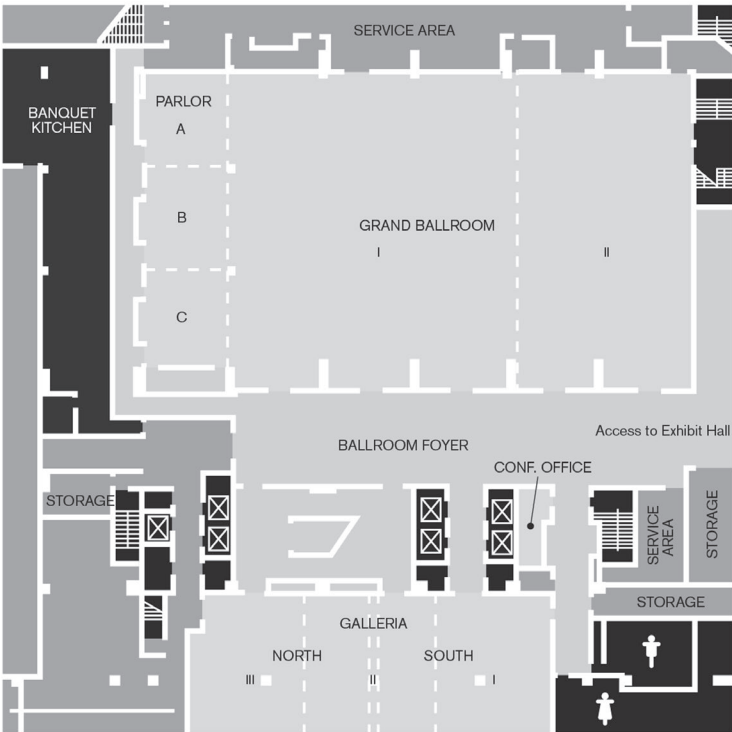

Plaza Level



Third Floor

