

# At-a-Glance Schedule



## Conference on Imaging Science

May 28–31, 2024

The Westin Peachtree Plaza  
Atlanta, Georgia, U.S.

### Online Program and Mobile App

Attendees are encouraged to visit

<https://www.siam.org/conferences/cm/program/program-and-abstracts/is24-program-abstracts>  
to view the Online Program Schedule.

The Mobile App and Online Program Schedule contain the most up-to-date information.  
A searchable abstract document is also posted.

### SIAM Events Mobile App



[www.tripbuildermedia.com/apps/siam](http://www.tripbuildermedia.com/apps/siam)

**siam** | Society for Industrial and  
Applied Mathematics

3600 Market Street, 6th Floor  
Philadelphia, PA 19104-2688 U.S.  
Telephone: +1-215-382-9800

Conference Email: [meetings@siam.org](mailto:meetings@siam.org) • Conference Web: [www.siam.org/conferences](http://www.siam.org/conferences)  
Membership and Customer Service: (800) 447-7426 (U.S. & Canada) or +1-215-382-9800 (worldwide)  
<https://www.siam.org/conferences/cm/conference/is24>

**Monday, May 27****Tuesday, May 28****Wednesday, May 29****4:00 p.m. – 6:00 p.m.**Registration  
*8th Floor Terrace***Tuesday, May 28****7:00 a.m. – 5:00 p.m.**Registration  
*8th Floor Terrace***8:00 a.m. – 8:15 a.m.**Welcome Remarks and Announcements  
*Peachtree CD - 8th Floor***8:15 a.m. – 9:00 a.m.****IP1** Exploiting Tensor Structure in Imaging Applications  
Misha E. Kilmer, Tufts University, U.S.  
*Peachtree CD - 8th Floor***9:00 a.m. – 9:30 a.m.**Coffee Break  
*8th Floor Terrace***9:00 a.m. – 4:30 p.m.**Exhibitor Hours  
*8th Floor Terrace***9:30 a.m. – 11:30 a.m.****Concurrent Sessions****MT1** Computational Optimal Transport in Imaging Science  
*Peachtree CD - 8th Floor***MS1** Advances in Low-dimensional Representations in Data and Imaging Science - Part I of II  
*Peachtree 1 - 8th Floor***MS2** Model- and Data-Driven Approaches in Motion Analysis - Part I of II  
*Peachtree 2 - 8th Floor***MS3** Open Source Software Solutions for Imaging Inverse Problems - Part I of II  
*Augusta A - 7th Floor***MS4** SDE- and PDE-based Sampling Methods for Imaging Inverse Problems - Part I of II  
*Augusta B - 7th Floor***MS5** Topological and Geometric Methods in Machine Learning for Imaging Applications - Part I of II  
*Augusta C - 7th Floor***MS6** Inverse Problems and Imaging: A Graduate Student Session - Part I of II  
*Augusta D - 7th Floor***MS7** Imaging Problems in Industry: Recent Advances in Modeling and Numerical Methods - Part I of II  
*Augusta E - 7th Floor***MS8** Lifting Methods and Nonlinear Inverse Problems in Imaging: From Theory to Practice  
*Augusta F - 7th Floor***11:30 a.m. – 1:00 p.m.**  
Lunch Break**1:00 p.m. – 1:45 p.m.****IP2** Numerical Understanding of Neural Networks: From Representation to Learning Dynamics  
Hongkai Zhao, Duke University, U.S.  
*Peachtree CD - 8th Floor***1:45 p.m. – 2:15 p.m.**Coffee Break  
*8th Floor Terrace***2:15 p.m. – 4:15 p.m.****Concurrent Sessions****MS9** Compression and Analysis for Large-scale Scientific Data  
*Peachtree 1 - 8th Floor***MS10** Model- and Data-Driven Approaches in Motion Analysis - Part II of II  
*Peachtree 2 - 8th Floor***MS11** Deep Unrolled Optimisation Methods for Inverse Imaging Problems - Part I of II  
*Augusta A - 7th Floor***MS12** Open Source Software Solutions for Imaging Inverse Problems - Part II of II  
*Augusta B - 7th Floor***MS13** SDE- and PDE-based Sampling Methods for Imaging Inverse Problems - Part II of II  
*Augusta C - 7th Floor***MS14** CANCELLED - Topological and Geometric Methods in Machine Learning for Imaging Applications - Part II of II  
*Augusta D - 7th Floor***MS15** Inverse Problems and Imaging: A Graduate Student Session - Part II of II  
*Augusta E - 7th Floor***MS16** Imaging Problems in Industry: Recent Advances in Modeling and Numerical Methods - Part II of II  
*Augusta F - 7th Floor***CP1** Topics in Imaging and Image Processing  
*Augusta G - 7th Floor***4:15 p.m. – 4:30 p.m.**  
Intermission**4:30 p.m. – 6:30 p.m.****PP1** Welcome Reception and Poster Session  
*Augusta 1-3 and Augusta Terrace - 7th Floor***7:45 a.m. – 5:00 p.m.**Registration  
*8th Floor Terrace***8:10 a.m. – 8:15 a.m.**Announcements  
*Peachtree CD - 8th Floor***8:15 a.m. – 9:00 a.m.****IP3** Signal Reconstruction from Phase-only Measurements, Dithered Quantization or Quantized Corrupted Sensing  
Michael K. Ng, Hong Kong Baptist University, Hong Kong  
*Peachtree CD - 8th Floor***9:00 a.m. – 9:30 a.m.**Coffee Break  
*8th Floor Terrace***9:00 a.m. – 4:30 p.m.**Exhibitor Hours  
*8th Floor Terrace***9:30 a.m. – 11:30 a.m.****Concurrent Sessions****MT2** Deep Learning Techniques for Wave-Based Imaging  
*Peachtree CD - 8th Floor***MS17** Advances in Inverse Problems with Model-based and Data-driven Approaches - Part I of III  
*Peachtree 1 - 8th Floor***MS18** Advances in Low-dimensional Representations in Data and Imaging Science - Part II of II  
*Peachtree 2 - 8th Floor***MS19** Data-Driven Methods for Analysis and Understanding of Images - Part I of II  
*Augusta A - 7th Floor***MS20** Deep Unrolled Optimisation Methods for Inverse Imaging Problems - Part II of II  
*Augusta B - 7th Floor***MS21** Recent Development in Theory and Algorithm for Super-resolution in Wave-based Imaging - Part I of III  
*Augusta C - 7th Floor***MS22** Advances in Generative Models, Differential Equations, and Inverse Problems - Part I of II  
*Augusta D - 7th Floor***MS23** Advancements in Compton Camera Imaging: From Theory to Applications - Part I of II  
*Augusta E - 7th Floor***MS24** Deep Learning in Biomedical Image Analysis and Reconstruction  
*Augusta F - 7th Floor***11:30 a.m. – 1:00 p.m.**

Lunch Break

**Wednesday, May 29****1:00 p.m. – 1:45 p.m.**

**SP1** SIAG/Imaging Science Best Paper Prize  
Lecture - Implicit Regularization in Nonconvex  
Statistical Estimation: Gradient Descent Converges  
Linearly for Phase Retrieval, Matrix Completion and  
Blind Deconvolution  
Cong Ma, University of Chicago, U.S.  
*Peachtree CD - 8th Floor*

**1:45 p.m. – 2:00 p.m.**

Intermission

**2:00 p.m. – 4:00 p.m.****Concurrent Sessions**

**MS25** Advances in Inverse Problems with Model-  
based and Data-driven Approaches - Part II of III  
*Peachtree 1 - 8th Floor*

**MS26** Mathematical Approaches Based on Sparse  
Data for Multidimensional Image Processing - Part I  
of II  
*Peachtree 2 - 8th Floor*

**MS27** Data-Driven Methods for Analysis and  
Understanding of Images - Part II of II  
*Augusta A - 7th Floor*

**MS28** Fast Methods for Forward and Inverse  
Problems  
*Augusta B - 7th Floor*

**MS29** Recent Development in Theory and  
Algorithm for Super-resolution in Wave-based  
Imaging - Part II of III  
*Augusta C - 7th Floor*

**MS30** New Methods in Nonlinear and Discrete  
Inverse Problems  
*Augusta D - 7th Floor*

**MS31** Implicit Neural Representations for Inverse  
Problems in Imaging  
*Augusta E - 7th Floor*

**MS32** Advances in Generative Models, Differential  
Equations, and Inverse Problems - Part II of II  
*Augusta F - 7th Floor*

**CP2** Learning Techniques in Imaging  
*Augusta G - 7th Floor*

**4:00 p.m. – 4:30 p.m.**

Coffee Break  
*8th Floor Terrace*

**4:30 p.m. – 6:30 p.m.****Concurrent Sessions**

**MS33** Advances in Inverse Problems with Model-  
based and Data-driven Approaches - Part III of III  
*Peachtree 1 - 8th Floor*

**MS34** Mathematical Approaches Based on Sparse  
Data for Multidimensional Image Processing - Part  
II of II  
*Peachtree 2 - 8th Floor*

**MS35** Goal-Oriented Uncertainty Quantification in  
Imaging Sciences - Part I of II  
*Augusta A - 7th Floor*

**Wednesday, May 29**

**MS36** Structure-Informed Machine Learning for  
Imaging and Physical Science - Part I of III  
*Augusta B - 7th Floor*

**MS37** Recent Strides in Deep Inverse Problems:  
From PDEs/ODEs, Neural Implicit Representations,  
and Beyond - Part I of II  
*Augusta C - 7th Floor*

**MS38** Recent Development in Theory and  
Algorithm for Super-resolution in Wave-based  
Imaging - Part III of III  
*Augusta D - 7th Floor*

**MS39** Advancements in Compton Camera Imaging:  
From Theory to Applications - Part II of II  
*Augusta E - 7th Floor*

**MS40** Shapes, Manifolds and Geometry in Imaging  
- Part I of II  
*Augusta F - 7th Floor*

**CP3** New Computational Tools in Imaging  
*Augusta G - 7th Floor*

**6:30 p.m. – 6:45 p.m.**

Intermission

**6:45 p.m. – 7:30 p.m.**

SIAG/IS Business Meeting  
\*Complimentary beer and wine will be served\*  
*Peachtree CD - 8th Floor*

**Thursday, May 30****7:45 a.m. – 5:00 p.m.**

Registration  
*8th Floor Terrace*

**8:10 a.m. – 8:15 a.m.**

Announcements  
*Peachtree CD - 8th Floor*

**8:15 a.m. – 9:00 a.m.**

**IP4** Scale-invariant Regularizations for Sparse  
Signal and Low-rank Tensor Recovery  
Yifei Lou, University of North Carolina at Chapel  
Hill, U.S.  
*Peachtree CD - 8th Floor*

**9:00 a.m. – 9:30 a.m.**

Coffee Break  
*8th Floor Terrace*

**9:00 a.m. – 4:30 p.m.**

Exhibitor Hours  
*8th Floor Terrace*

**Thursday, May 30****9:30 a.m. – 11:30 a.m.****Concurrent Sessions**

**MS41** Increasing Fairness in ML Through Improved  
Data Assessment and Standardization in Medical  
Imaging and Beyond - Part I of II  
*Peachtree 1 - 8th Floor*

**MS42** Goal-Oriented Uncertainty Quantification in  
Imaging Sciences - Part II of II  
*Peachtree 2 - 8th Floor*

**MS43** Structure-Informed Machine Learning for  
Imaging and Physical Science - Part II of III  
*Augusta A - 7th Floor*

**MS44** Synergy in Segmentation: Bridging Classical  
and Deep Learning Approaches - Part I of III  
*Augusta B - 7th Floor*

**MS45** Recent Strides in Deep Inverse Problems:  
From PDEs/ODEs, Neural Implicit Representations,  
and Beyond - Part II of II  
*Augusta C - 7th Floor*

**MS46** Frontiers in Deep Image Reconstruction,  
Restoration Across Diverse Modalities - Part I of II  
*Augusta D - 7th Floor*

**MS47** Bregman-based Optimisation Approaches for  
Imaging Inverse Problems  
*Augusta E - 7th Floor*

**MS48** Shapes, Manifolds and Geometry in Imaging  
- Part II of II  
*Augusta F - 7th Floor*

**CP4** Mathematical Methods in Imaging Sciences  
*Augusta G - 7th Floor*

**11:30 a.m. – 1:00 p.m.**

Lunch Break

**1:00 p.m. – 1:45 p.m.**

**IP5** Multimodal Self-Supervised Learning and  
Applications to Visual Data Understanding  
Coloma Ballester, Universitat Pompeu Fabra, Spain  
*Peachtree CD - 8th Floor*

**1:45 p.m. – 2:00 p.m.**

Intermission

**2:00 p.m. – 4:00 p.m.****Concurrent Sessions**

**MS49** Increasing Fairness in ML Through Improved  
Data Assessment and Standardization in Medical  
Imaging and Beyond - Part II of II  
*Peachtree 1 - 8th Floor*

**MS50** Structure-Informed Machine Learning for  
Imaging and Physical Science - Part III of III  
*Peachtree 2 - 8th Floor*

**MS51** Advances in Electrical Impedance  
Tomography: From Theory to Clinical Application -  
Part I of II  
*Augusta A - 7th Floor*

**MS52** Synergy in Segmentation: Bridging Classical  
and Deep Learning Approaches - Part II of III  
*Augusta B - 7th Floor*

## Thursday, May 30

## Friday, May 31

## Friday, May 31

**MS53** Model-Based and Data-Driven Hybrid Methods in Computational Imaging - Part I of II  
*Augusta C - 7th Floor*

**MS54** Frontiers in Deep Image Reconstruction, Restoration Across Diverse Modalities - Part II of II  
*Augusta D - 7th Floor*

**MS55** Recent Developments on Variational Models and Fast Algorithms for Image Restoration - Part I of II

*Augusta E - 7th Floor*

**MS56** Shapes, Manifolds and Geometry in Imaging  
*Augusta F - 7th Floor*

**CP5** Sparsity and Tensor Techniques

*Augusta G - 7th Floor*

**4:00 p.m. – 4:30 p.m.**

Coffee Break  
*8th Floor Terrace*

**4:30 p.m. – 6:30 p.m.**

**Concurrent Sessions**

**MS57** Advances in Numerical Linear Algebra Techniques for Inverse Imaging Problems - Part I of II

*Peachtree 1 - 8th Floor*

**MS58** Advances in Electrical Impedance Tomography: From Theory to Clinical Application - Part II of II

*Peachtree 2 - 8th Floor*

**MS59** Synergy in Segmentation: Bridging Classical and Deep Learning Approaches - Part III of III  
*Augusta A - 7th Floor*

**MS60** Model-Based and Data-Driven Hybrid Methods in Computational Imaging - Part II of II  
*Augusta B - 7th Floor*

**MS61** Surface reconstruction: PDEs, Variational, and Deep Learning Methods - Part I of II  
*Augusta C - 7th Floor*

**MS62** Advanced Approaches in Inverse Problems and Applications - Part I of III  
*Augusta D - 7th Floor*

**MS63** Inverse Problems for Partial Differential Equations: Rising Stars - Part I of II  
*Augusta E - 7th Floor*

**MS64** Recent Developments on Variational Models and Fast Algorithms for Image Restoration - Part II of II

*Augusta F - 7th Floor*

**CP6** Imaging in Applications

*Augusta G - 7th Floor*

**7:45 a.m. – 2:30 p.m.**

Registration  
*8th Floor Terrace*

**8:10 a.m. – 8:15 a.m.**

Closing Remarks  
*Peachtree CD - 8th Floor*

**8:15 a.m. – 9:00 a.m.**

**IP6** Learned Forward and Inverse Problems for PDES in Imaging  
Simon Arridge, University College London, United Kingdom  
*Peachtree CD - 8th Floor*

**9:00 a.m. – 9:30 a.m.**

Coffee Break  
*8th Floor Terrace*

**9:00 a.m. – 1:00 p.m.**

Exhibitor Hours  
*8th Floor Terrace*

**9:30 a.m. – 11:30 a.m.**

**Concurrent Sessions**

**MS65** Recent Challenges and Developments on Multi-way Data Analysis: Imaging and Tensors - Part I of II

*Peachtree 1 - 8th Floor*

**MS66** Advances in Numerical Linear Algebra Techniques for Inverse Imaging Problems - Part II of II

*Peachtree 2 - 8th Floor*

**MS67** Deep Learning for Imaging Science - Part I of II  
*Augusta A - 7th Floor*

**MS68** Computational Optimal Transport meets Imaging - Part I of II  
*Augusta B - 7th Floor*

**MS69** Surface reconstruction: PDEs, Variational, and Deep Learning Methods - Part II of II  
*Augusta C - 7th Floor*

**MS70** Numerical Linear Algebra Meets Inverse Problems in Imaging - Part I of II  
*Augusta D - 7th Floor*

**MS71** Advanced Approaches in Inverse Problems and Applications - Part II of III  
*Augusta E - 7th Floor*

**MS72** Inverse Problems for Partial Differential Equations: Rising Stars - Part II of II  
*Augusta F - 7th Floor*

**CP7** Noise and Statistics in Imaging  
*Augusta G - 7th Floor*

**11:30 a.m. – 1:00 p.m.**

Lunch Break

**1:00 p.m. – 1:45 p.m.**

**IP7** Krylov Methods for Imaging: Classical and Novel Algorithmic Approaches  
Silvia Gazzola, University of Bath, United Kingdom  
*Peachtree CD - 8th Floor*

**1:45 p.m. – 2:15 p.m.**

Coffee Break  
*8th Floor Terrace*

**2:15 p.m. – 4:15 p.m.**

**Concurrent Sessions**

**MS73** Recent Challenges and Developments on Multi-way Data Analysis: Imaging and Tensors - Part II of II

*Peachtree 1 - 8th Floor*

**MS74** Open Challenges in Inverse Problems for Biomedical Images

*Peachtree 2 - 8th Floor*

**MS75** New Advances in Multi-frame Imaging  
*Augusta A - 7th Floor*

**MS76** Deep Learning for Imaging Science - Part II of II

*Augusta B - 7th Floor*

**MS77** Computational Optimal Transport meets Imaging - Part II of II  
*Augusta C - 7th Floor*

**MS78** Numerical Linear Algebra Meets Inverse Problems in Imaging - Part II of II  
*Augusta D - 7th Floor*

**MS79** Advances in Multiscale and Multilayer Techniques for Image Restoration  
*Augusta E - 7th Floor*

**MS80** Advanced Approaches in Inverse Problems and Applications - Part III of III  
*Augusta F - 7th Floor*

**ABBREVIATION KEY**

**CP** = Contributed Presentation Session

**IP** = Invited Plenary Speaker

**MS** = Minisymposium

**MT** = Minitutorial

**PP** = Poster Session

**SP** = Special Lecture

**Thank you to our  
FUNDING AGENCY**



SIAM and the Organizing Committee wish to extend their thanks and appreciation to the U.S. National Science Foundation for its support of this conference.

# SIAM Activity Group on Imaging Science (SIAG/IS)

[www.siam.org/Activity-Groups/IS](http://www.siam.org/Activity-Groups/IS)



## *A great way to get involved!*

Collaborate and interact with engineers and scientists with an interest in the mathematical and computational aspects of imaging.

### ACTIVITIES INCLUDE

- Biennial conference
- Special sessions at SIAM meetings

### BENEFITS OF SIAG/IS MEMBERSHIP

- Listing in the SIAG's online membership directory
- Additional \$15 discount on registration at the SIAM Conference on Imaging Science
- Subscription to SIAM Journal on Imaging Sciences
- Access to **SIAM Engage** online community for SIAG/IS
- Eligibility for candidacy for SIAG/IS office
- Participation in the selection of SIAG/IS officers



### ELIGIBILITY FOR SIAG/IS MEMBERSHIP

- Must be a current SIAM member

### COST

- \$15 per year
- Outreach members can join one SIAM Activity Group for free and student members can join two for free!

## 2024–2025 SIAG/IS OFFICERS

**Chair:** Gabriele Steidl, *Technical University Berlin*

**Vice Chair:** Kui Ren, *Columbia University*

**Program Director:** Yifei Lou, *University of North Carolina at Chapel Hill*

**Secretary:** Fatma Terzioglu, *North Carolina State University*

# Students:

## Participate in Your Profession By Getting Involved with SIAM!



- Free and discounted memberships, conference registrations, and publications
- Free membership in two specialized activity groups—networks of professionals within applied math and computational science that organize conferences and newsletters, award prizes, and often post job and fellowship opportunities in the SIAM Engage Online Community
- Student travel awards to SIAM conferences
- Student chapters — get involved or start one at your school
- Publish in *SIAM Undergraduate Research Online* (SIURO) — share research and experience the journal review process
- Free resources about career options in applied math and computational science at [siam.org/careers](http://siam.org/careers)
- Career advice in *SIAM News*
- Prizes to award excellence
- Participate in Gene Golub SIAM Summer School (G2S3)



“SIAM is important because professional organizations are vital in bringing up students and early career scientists. Making connections and providing a coherent and consistent community that meets throughout the year is an invaluable thing. Publishing is important too, so SIAM journals are an excellent venue for in-depth work.”

— Jed Brown, SIAM Member, University of Colorado



Take advantage of SIAM programs, resources, and opportunities for involvement! Learn more: [siam.org/students](http://siam.org/students)

# The Westin Peachtree Plaza Floor Plans

## Augusta Level, Seventh Floor

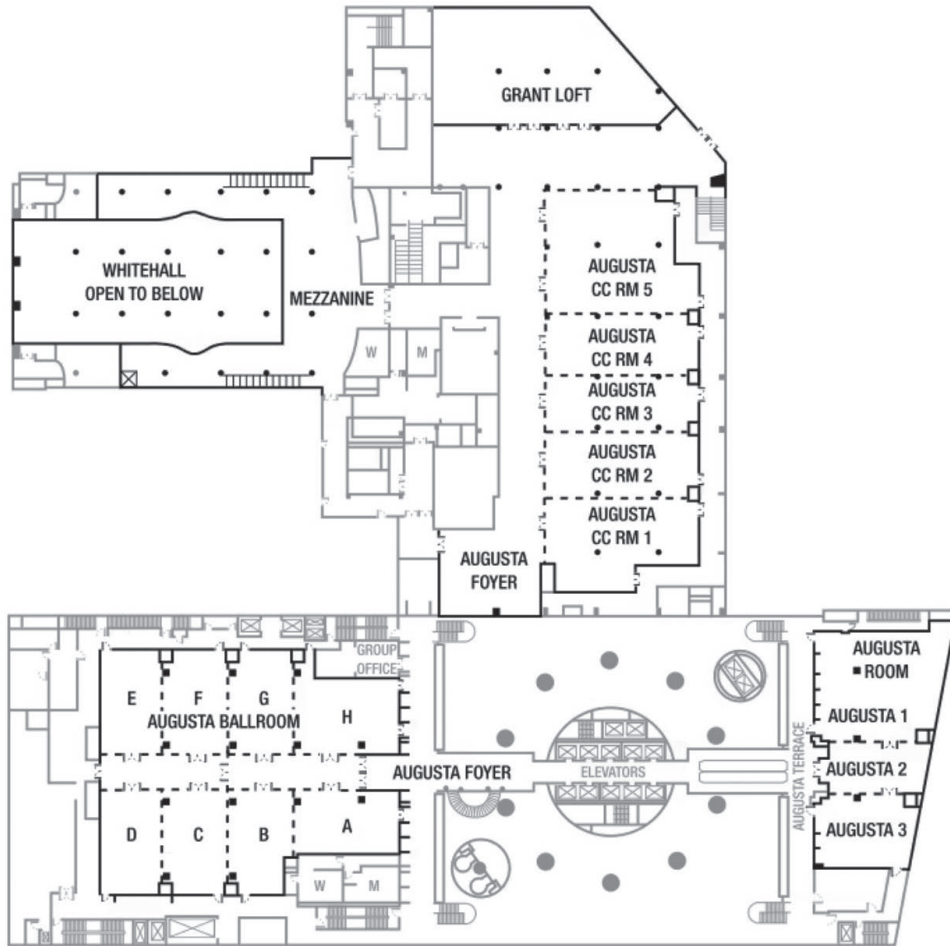

## Peachtree Level, Eighth Floor

